

Dear Partners,

This is related to the warranty for Angle type SKC-PTA-L300/ L600 of Cordless Battery Screwdriver. From now on, Kilews offer **2 year warranty for the motor, gear box and 90 degree angle head of SKC-PTA-L300/ L600** under normal use & 8 hours a day.

Enclosed is the warranty card for your reference.

We trust this is our competitive advantage to promote Angle type SKC-PTA-L300/ L600. Please be sure to share this information to your customers.

Best Regards,

Loover-Kilews Industrial Co., Ltd.



KILEWS Automatic Series
WARRANTY CARD

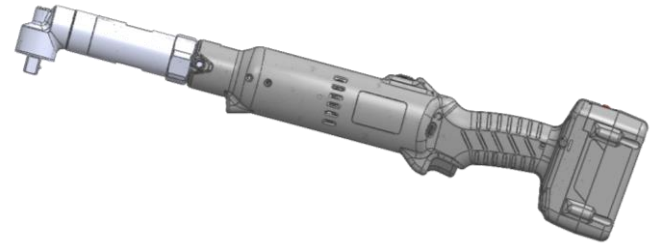

Model no.:

SKC-PTA-L_____

KILEWS Industrial Co., Ltd.

<http://www.kilews.com.tw>

Made in TAIWAN



TERMS & CONDITIONS

- Two (2) year limited warranty for Kilews cordless screwdriver: under normal use eight (8) hours a day, total of three thousand (6,000) hours. This limited warranty shall not applicable if total operation time is more than 3,000 hours or 2 year after purchase.
- Limited warranty comparison table. (consumption parts are not included)

Series	SKC-PTA-L600		SKC-PTA-L300
Motor	Two (2) years		Two (2) years
Gear Box	Two (2) years		Two (2) years
90° Angle Head	Two (2) years		Two (2) years
Half year	Screwdriver (Housing)	Bearing	Suspension Hook Ring Group
	Trigger Switch	Heat Sink	Clamp
	Bit	S waist hook	Forward/Reverse Spring
	Forward/Reverse Switch	Slip resistant soft cover	H/M/L Level Switch

*The gear box of Impact screwdriver is defined as consumption parts due to heavy impact abrasion

- The warranty will be void and null if :
 - Product has been misused or abused, or damage caused by natural and man-made disasters •
 - Product has been disassembled, repaired or modified by unauthorized person of KILEWS •
 - The product serial number or warranty card has been removed, erased, defaced, altered or is illegible •
 - The Company was not promptly informed of any change of address or the ownership of the product(s) •
 - Use non authentic parts or lubricants etc.
- The Company will be no liable for any direct or indirect loss arising from breakdown of the product(s) •
- Under this warranty, the Company only provided for service at any time during normal business hours.
Unavoidable emergency service may be requested outside normal business hours, such service if available will be provided and charged per call •
- The Warranty does not be allowed to transfer without the consent of the Company •
- Please keep and present the Official Receipt and Warranty Card to our technician for inspection during each service •
- KILEWS MAINTENANCE CENTERS as below :
Address: NO.30, Lane 83, Hwa-Cheng Road, Hsin Chuang district, New Taipei City, Taiwan, R.O.C.
TEL:886 2 29971912 FAX:886 2 29969023
Please visit our website at (<http://www.kilews.com>). for information /OEM/maintenance

WARRANTY CARD

MODEL NO. : _____
 SERIAL NO. : _____
 Date of Purchase : _____



INTERNATIONAL WARRANTY CONDITIONS

- Purchases of Kilews cordless screwdriver for overseas destinations will be covered by the service warranty till the products are delivered to client assigned destinations. Branches and distributors in overseas of Kilews will take no responsibility if there is any loss or damage raising from transportation that is arranged by customer' s side. The fees for spare parts or repairing will be charged as condition above.
- Products purchased in Taiwan shall be fully repaired at Kilews expense during warranty period. Under warranty period, it will be offered with free replacements to buyers but branches or distributors of Kilews will charge the fees for repairing of products that are using in overseas factories.
- During the service warranty period, products send to overseas shall be charged for basic repair expenses. The buyer shall present the warranty card issued by Kilews to negotiate with local maintenance stores. Reasonable fees shall be charged to the buyers by conditions as number of pieces, usage condition of screwdrivers, period of time, and workload.
- During warranty period, users shall present warranty cards for repairing. Failure to present a complete warranty cards shall be considered as expiration of the card with no warranty service. Local distributors will charge all related fees about maintenance and spare parts based on company regulation.
- Once the date on warranty card expired, fees will be charged no matter where you send products for repairing or maintenance. Kilews will be liable for repairing of screwdrivers from dealers in Taiwan, distributors and branch offices in overseas of Kilews, sold from the OEM-brand company included. Kilews urge the above relevant company to offer full after-service based on principles of honesty, reliability and good attitude. If there will be any poor service found, please notice us directly. Kilews will always have to offer customers satisfied service on the basis of customer and best service. Thank you for your support and assistance, we are deeply appreciated •

KILEWS SKC-PTA & SKC-PTS & SKC-PTI WARRANTY CARD RETURN SLIP

Model No. : _____
 Serial No. : _____
 Customer's Name : _____
 Tel No. : _____
 Address : _____
 Date of Purchase : _____
 Without dealer's chop and date of purchase, this warranty card will be null and void.



Dealer's Chop :

Without dealer's chop and date of purchase, this warranty card will be null and void.